

CWM7.4 S2

1

1 x

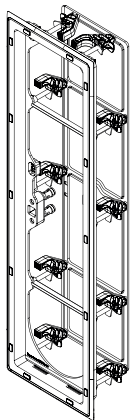

1 x

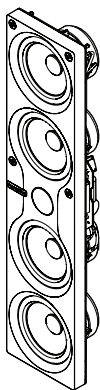

1 x



1 x

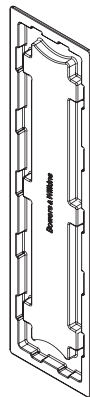

1 x

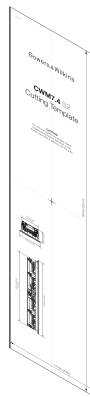

2

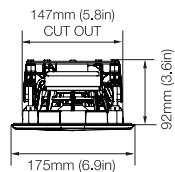
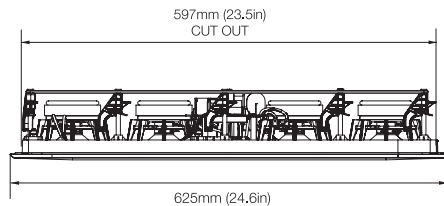
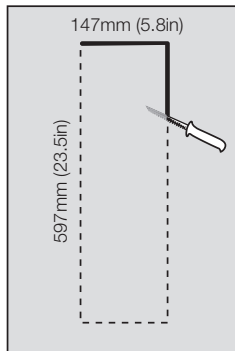
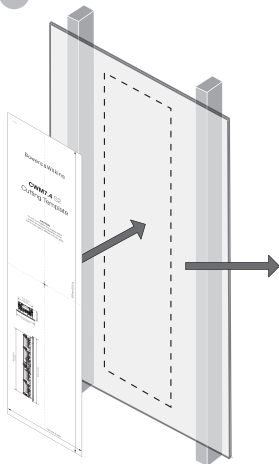

3

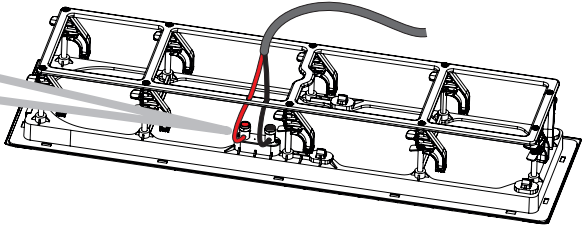
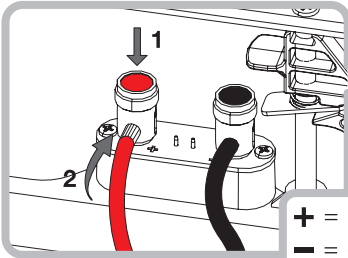

4

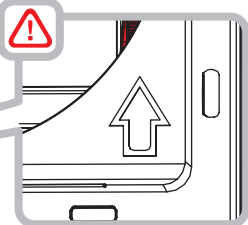
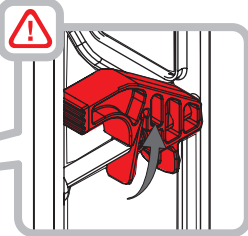
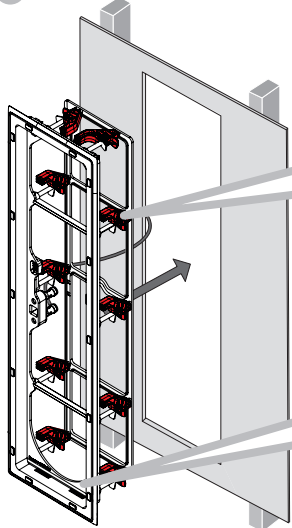

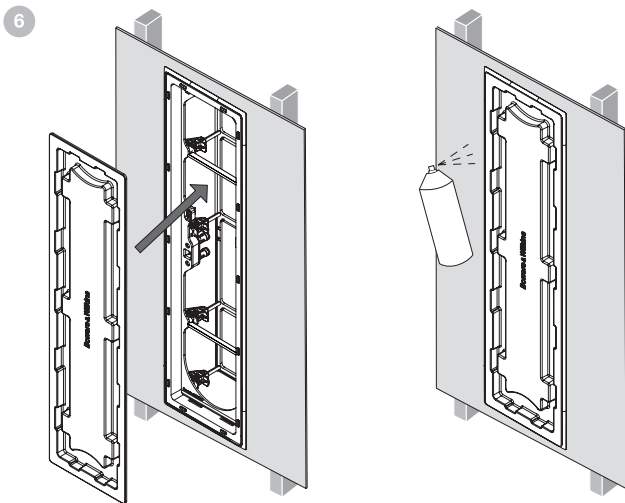
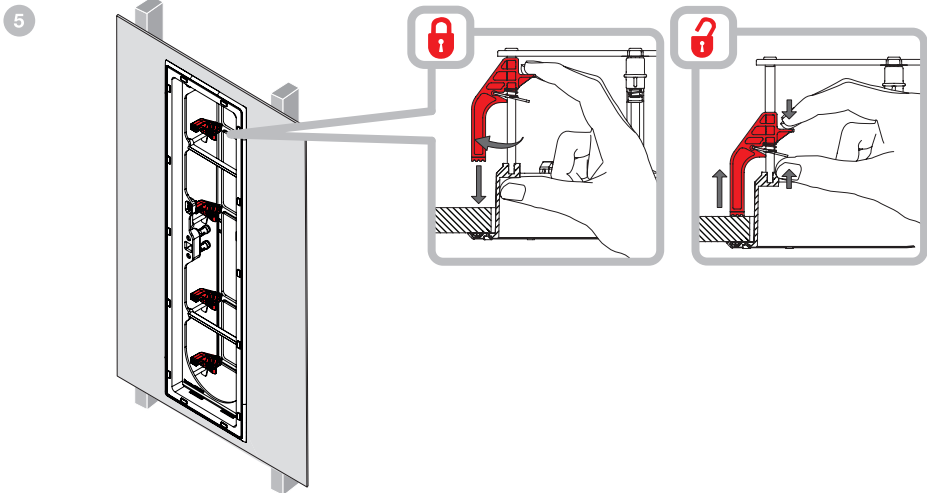

7

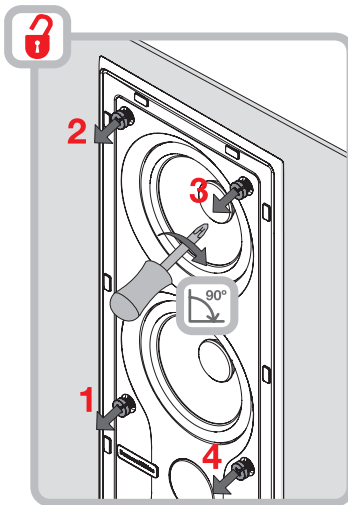
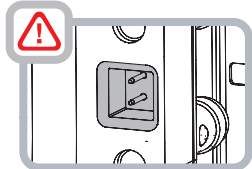
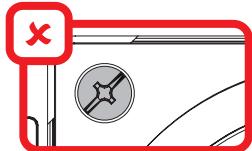
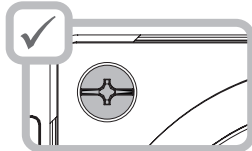
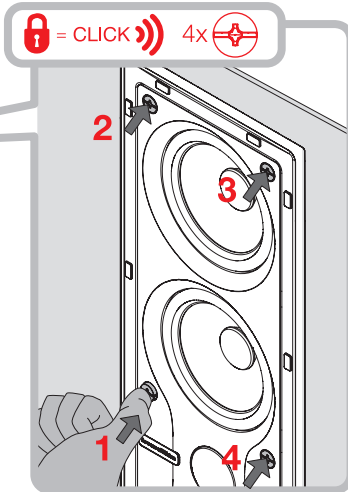
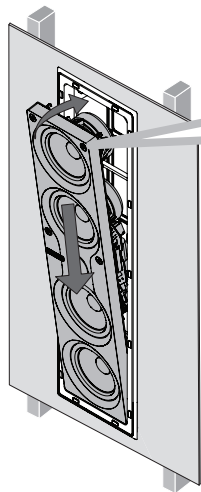

8

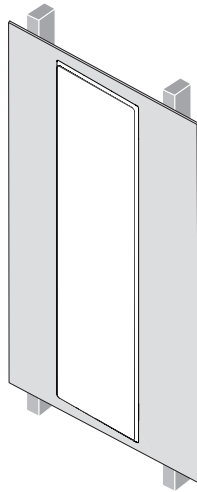
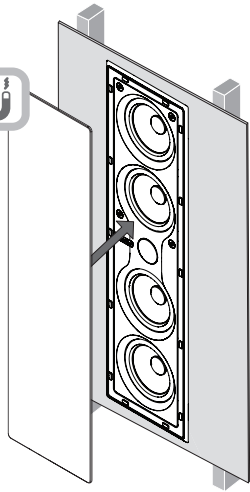



ENGLISH

Installation must be carried out in accordance with national building and wiring regulations.

FRAŅÇAIS

L'installation doit ętre ręalisęe en conformitę avec les ręglementations nationales en matięre de construction et de cęblage.

DEUTSCH

Bei der Installation męssen die nationalen Baubestimmungen und Verdrahtungsvorschriften eingehalten werden.

ESPAŅOL

La instalaci3n debe realizarse en concordancia con la normativa nacional en materia de construcci3n y cableado de edificios.

PORTUGUĘS

A instala33o tem de ser efectuada em conformidade com as regulamenta33es nacionais relativas a edifícios e respectivas instala33es elęctricas.

ITALIANO

L'installazione deve essere eseguita nel rispetto delle norme nazionali in materia di edilizia e di impianti elettrici.

NETDERLANDS

De installatie moet in overeenstemming met de nationale bouw- en bedradingsvoorschriften worden uitgevoerd.

ĀESKY

Montáž musf bęt prováděna v souladu s męstními stavebními a elektroinstalaĀnními předpisy.

SLOVENĀINA

Instalacija musf bęti vykonana v sůlade so zákonnými smernicami o stavbe a kábl0vani.

MAGYAR

A szerelęs a nemzeti ępítęsi ęs vezetękekre vonatkoz3 el3r3soknak megfelel3en kell elvęgezni.

POLSKI

Instalacje należy przeprowadziĀ zgodnie z krajowymi regulacjami budowlanymi i przepisami dotyczęcymi instalacji elektrycznych.

TÜRKĀE

Kurulum, ulusal inřaat ve elektrik řebekesi d¼zenlemelerine uygun olarak gerĀekleřtirilmelidir.

ΕΛΛΗΝΙΚΑ

Η εγκατάσταση θα πρέπει να γίνεται με την εφαρμογή των εθνικών οικοδομικών κανονισμών, καθώς και των κανονισμών αναφορικά με τη συνδεσμολογία και των καλωδιώσεων.

РУССКИЙ

Установка должна бęть выполнена в соответствии с государственными строительными и пожарными нормами.

日本語

インストールは、国が定める建造物及び配線のレギュレーションに従って行わなければならない。

简体中文

安装必须按照国家建筑和接线规定进行。

繁体中文

安装必须按照国家建筑和接线规定进行。

한국어

설치는 국가 건물 및 배선 규정에 따라 수행해야 합니다.

B&W Group Ltd.
Dale Road Worthing
West Sussex
BN11 2BH England

